



ZENITHY LAVILLE
LUXURY VILLAS





**WHERE
MODERN
LIVING
EMBRACES
NATURE**



Minutes from British International School

ZENITHY LA VILLE is a collection of 22 modern pool villas in Koh Kaew, one of Phuket's most convenient residential areas. Positioned close to international schools, marinas, and Phuket Town, the project offers a balance of privacy and accessibility—designed for comfortable, long-term living.

DESIGNED FOR FAMILIES WHO VALUE TIME, PRIVACY, AND EVERYDAY EASE

1.8 km to British International School

No long commutes. No daily stress. Just a simpler routine for the whole family.

Private Pool Villas in a Secure Community

Gated living with space, privacy, and peace of mind.

Modern Design Built for Real Living

Thoughtfully planned layouts, natural light, and seamless indoor-outdoor flow.



A Villa Designed for Everyday Living

Spacious layouts, private outdoor living, and thoughtful design throughout.

- 351–357 sqm built-up area
- 3 bedrooms, 4 bathrooms
- Open-plan living and dining
- Private pool and garden

Open, connected living space.

- Double-height living area
- Seamless indoor-outdoor flow
- Fully equipped kitchen with island
- Ground floor master suite
- Family room on second floor
- Dedicated home office area



Commercial Zone A

Commercial Zone B

Master Plan



Key Plan

Zenithy La Ville Oasis

12 Villas

Zenithy La Ville Tropical

10 Villas

PROJECT DETAILS

PROJECT AREA	Approx. 7 Rai.
PROJECT TYPE	2 Storey Single House
LAND AREA	259 - 472.35 Sq.m.
BUILDING STYLE	Modern Contemporary
NUMBER OF VILLAS	22 Villas



Type A



Plot Area : 300.52 – 439.91 Sq.m.

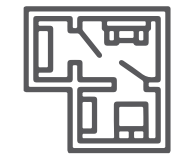

Useable Area : 357.40 Sq.m.



Bedrooms : 3



Bathrooms : 4



Car Park : 2 Lots



Pool Size : 3 x 10 x 1.45m



FLOOR PLAN – FIRST FLOOR

1. ENTRANCE	6.40 sq.m.
2. PARKING	36.00 sq.m.
3. PUMP ROOM	4.30 sq.m.
4. POOL	37.00 sq.m.
5. OUTDOOR SHOWER	2.50 sq.m.
6. OUTDOOR DINING	11.00 sq.m.
7. LIVING AREA	20.00 sq.m.
8. DINING AREA	15.00 sq.m.
9. KITCHEN AREA	12.00 sq.m.
10. LAUNDRY	6.60 sq.m.
11. TOILET	3.30 sq.m.
12. STAIRS	8.20 sq.m.
13. MASTER BEDROOM	34.00 sq.m.
14. SERVICE AREA	6.00 sq.m.
15. SERVICE STORAGE	3.50 sq.m.
16. STORAGE	2.50 sq.m.
17. STONE GARDEN	7.60 sq.m.
18. TERRACE	27.20 sq.m.
19. ELECTRICAL PANEL ROOM	1.00 sq.m.

FLOOR PLAN - 1st FLOOR 244.10 sq.m.

Type A



Plot Area : 300.52 – 439.91 Sq.m.

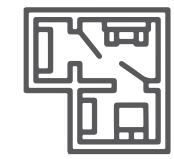

Useable Area : 357.40 Sq.m.



Bedrooms : 3



Bathrooms : 4



Car Park : 2 Lots



Pool Size : 3 x 10 x 1.45m



FLOOR PLAN – SECOND FLOOR

19. CORRIDOR	6.60 sq.m.
20. BEDROOM 2	37.10 sq.m.
21. BEDROOM 3	28.10 sq.m.
22. FAMILY ROOM	11.00 sq.m.
23. WORKING AREA	6.00 sq.m.
24. OUTDOOR LIVING	16.30 sq.m.
25. STAIRS	8.20 sq.m.

FLOOR PLAN - 2nd FLOOR 113.30 sq.m.

Total 357.40 sq.m.

Type B



Plot Area : 259 – 472.35 Sq.m.

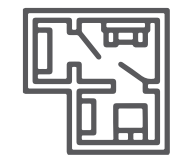

Useable Area : 351.61 Sq.m.



Bedrooms : 3



Bathrooms : 4



Car Park : 2 Lots



Pool Size : 3 x 9.5 x 1.45m



FLOOR PLAN – FIRST FLOOR

1. ENTRANCE	6.40 sq.m.
2. PARKING	36.00 sq.m.
3. PUMP ROOM	4.30 sq.m.
4. POOL	35.00 sq.m.
5. OUTDOOR SHOWER	1.56 sq.m.
6. OUTDOOR DINING	8.95 sq.m.
7. LIVING AREA	20.00 sq.m.
8. DINING AREA	15.00 sq.m.
9. KITCHEN AREA	12.00 sq.m.
10. LAUNDRY	6.60 sq.m.
11. TOILET	3.30 sq.m.
12. STAIRS	8.20 sq.m.
13. MASTER BEDROOM	34.00 sq.m.
14. SERVICE AREA	6.00 sq.m.
15. SERVICE STORAGE	3.50 sq.m.
16. STORAGE	2.50 sq.m.
17. STONE GARDEN	7.60 sq.m.
18. TERRACE	26.40 sq.m.
19. ELECTRICAL PANEL ROOM	1.00 sq.m.

FLOOR PLAN - 1st FLOOR 238.31 sq.m.

Type B



Plot Area : 259 – 472.35 Sq.m.

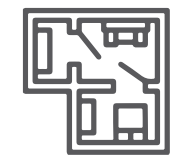

Useable Area : 351.61 Sq.m.



Bedrooms : 3



Bathrooms : 4



Car Park : 2 Lots



Pool Size : 3 x 9.5 x 1.45m



FLOOR PLAN – SECOND FLOOR

19. CORRIDOR	6.60 sq.m.
20. BEDROOM 2	37.10 sq.m.
21. BEDROOM 3	28.10 sq.m.
22. FAMILY ROOM	11.00 sq.m.
23. WORKING AREA	6.00 sq.m.
24. OUTDOOR LIVING	16.30 sq.m.
25. STAIRS	8.20 sq.m.

FLOOR PLAN - 2nd FLOOR 113.30 sq.m.

Total 351.61 sq.m.

OASIS ZONE

—





Sophisticated. Rich. Intimate. The Oasis Collection offers a deeper, more dramatic design direction. Rich tones, layered textures, and darker finishes create interiors that feel grounded, elegant, and quietly luxurious.

Clean architectural lines give the spaces a refined modern character, while the darker palette provides a sense of warmth and privacy.











TROPICAL ZONE

—





Light. Airy. Luminous. The Tropical Collection celebrates the brightness of island living. A light, neutral palette combined with warm natural accents creates interiors that feel open, relaxed, and filled with natural light.

Large expanses of glass and open living spaces strengthen the connection between the home and the garden, allowing sunlight and greenery to become part of the everyday living experience.



Dec 31, 202
30









BRITISH INTERNATIONAL SCHOOL

ZENITHY L VILLE

LUXURY VILLAS

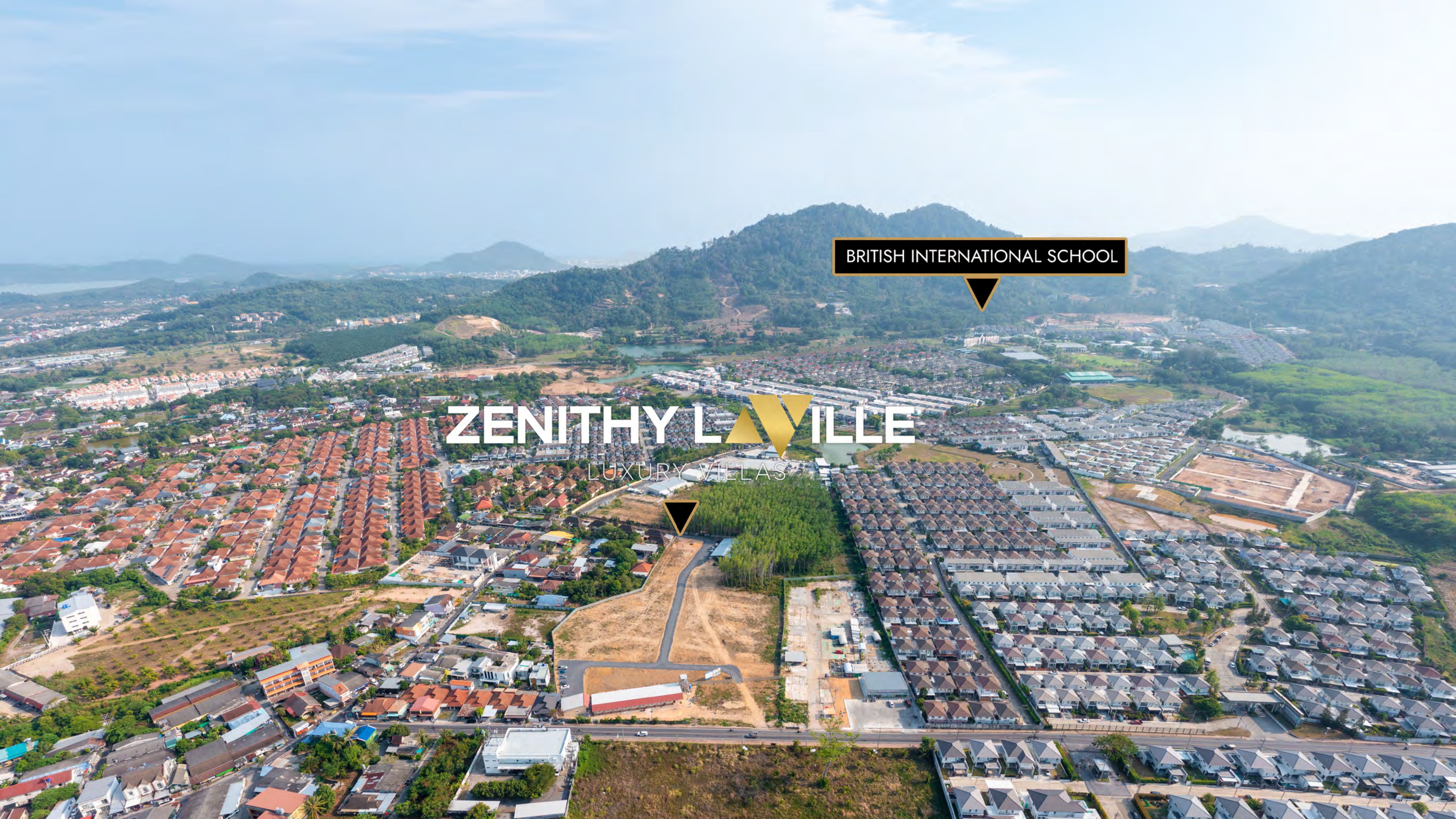

Location

Zenithy La Ville is located in Koh Kaew, just moments from the British International School, Boat Lagoon, and key lifestyle conveniences. The area offers quick access to Phuket Town, marinas, golf courses, shopping, and healthcare—while remaining peaceful, private, and comfortably removed from the island’s busiest areas.

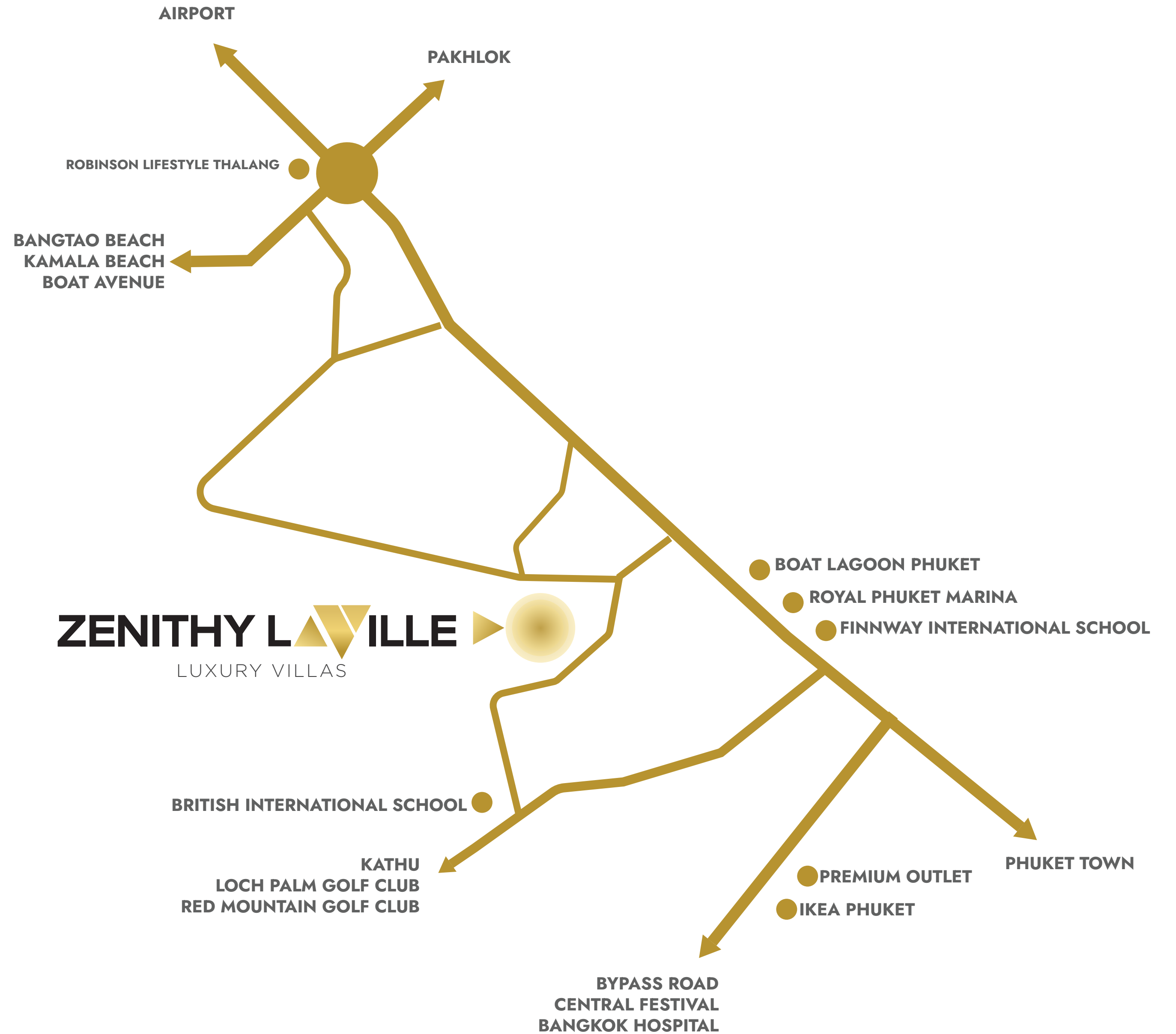

ZENITHY LA VILLE
LUXURY VILLAS

> AIRPORT / BANG TAO

Thep Krasatri Rd

Royal Phuket Marina

Phuket Boat Lagoon

Finnway International School

British International School

Premium Outlet

< TO PATONG / KATHU

< TO PHUKET TOWN / CHALONG
Thanon Chaloem Phra Kiat R.9 (Bypass Road)

TO PHUKET TOWN >
Thep Krasatri Rd

Popular Amenities

- 1.8 km British International School
- 3.0 km Finnway International School
- 4.0 km Phuket Boat Lagoon
- 4.0 km Robinson Lifestyle Thalang
- 4.5 km Royal Phuket Marina
- 4.5 km Premium Outlet
- 6.0 km Ikea Phuket
- 9.5 km Loch Palm Golf Club
- 9.5 km Red Mountain Golf Club
- 10.0 km Lotus's Phuket
- 10.5 km QSI International School of Phuket
- 10.5 km Bangkok Hospital
- 11.0 km Andamanda Phuket
- 12.0 km Central Phuket Festival
- 12.0 KM Bangkok Hospital Siriroj
- 12.0 km Index Living Mall Phuket
- 13.0 km Bang Tao Beach
- 13.5 km Kanjonkiet International School
- 20.0 km Patong Beach
- 22.5 km Phuket International Airport



British International School



Royal Phuket Marina



Robinson Lifestyle Thalang



Loch Palm Golf Club



Andamanda Phuket





**WHERE
LIFE
FEELS
EFFORTLESS**



